



Magnetic drive pumps

**NEW** **MDM50/65-2**



The Heart of Industry

# MDM50-2 and MDM65-2 have achieved a higher head and a larger flow rate while retaining the advantages of the MDM series.

- Maximum head about 90m, Maximum flow rate 1800L/min, expanded selection range. (see the figure below)
- Newly designed high-efficiency magnetic coupling. Motor output up to 30kW.
- Withstand pressure 1.6MPa, high specific gravity liquid can be transferred.
- Connection flange, compatible with JIS, ISO, ANSI standards.
- Installation dimensions compliant with ISO standards. (For pump with common base)
- Ability to withstand various abnormal operations such as dry run operation. (Iwaki original Non-contact system)

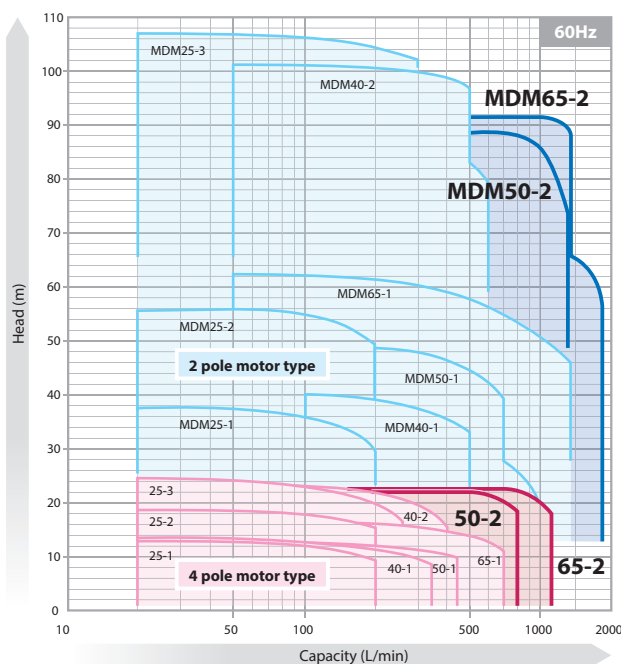
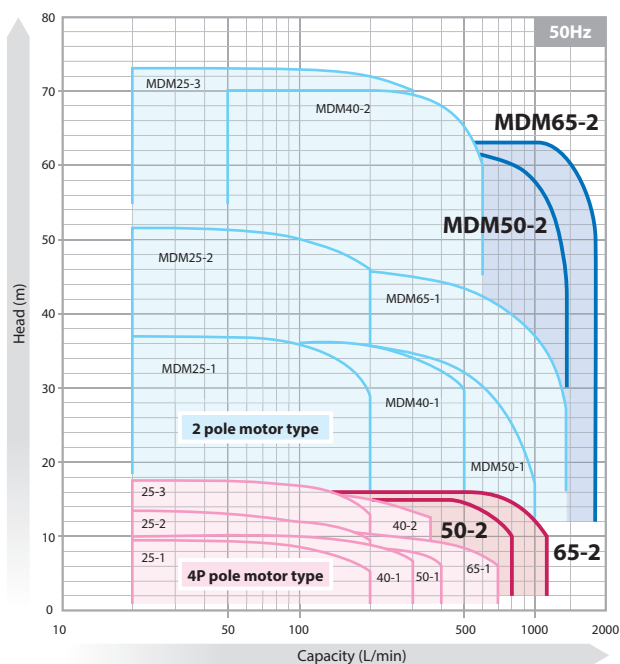

MDM50-2



### High efficiency and low NPSH by optimizing design

(Improvement of wetted parts structure)

We pursued hydraulic efficiency by utilizing CFD. As a result, best-in-class pump efficiency has been achieved. The newly designed impeller suppresses the occurrence of cavitation. The suction characteristics have also improved.

Note1: CFD (Computational Fluid Dynamics)  
 Note2: Comparison with the equivalent size of magnet pump (Our company / other companies)



### Miniaturization / Lightening

Footprint reduced by 27%, weight reduced by about 9%, compared with MDE series. (Pump of equivalent performance)



### Withstand pressure 1.6MPa

Adopting a rear casing cover made of CFRP achieves high pressure resistance. (Carbon fiber reinforced plastic) Pumps can handle high specific gravity liquids. ①



### New shape bearing

Improved resistance to abnormal operation and slurry liquid. ②



### Improved maintainability

Addition of maintenance bolts makes disassembly and assembly safer and easier than conventional products. ③



### Split front casing

The casing cover and resin casing can be separated, reducing maintenance costs. ④

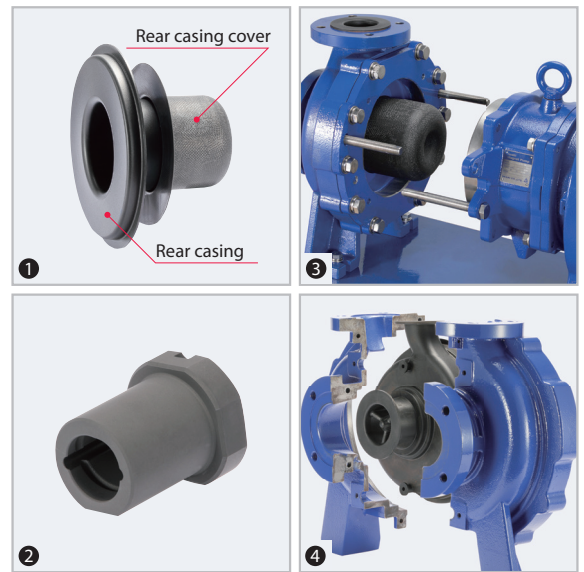

### Wet-end materials

**Impeller**  
CFRETFE

**Front casing**  
CFRETFE

**Bearing**  
CF : High density carbon  
KK : SiC

**Spindle**  
CF : High purity alumina ceramic  
KK : SiC

**Liner ring**  
CF : High purity alumina ceramic  
KK : SiC

**Mouth ring**  
CF : PTFE (with filler)  
KK : SiC

**Gasket**  
PTFE

**Magnet capsule**  
CFRETFE

**Rear casing cover**  
CFRP

**Rear casing**  
CFRETFE

**Rear thrust**  
PTFE (with filler)

# Pump identification

**MDM 65 - 200 2 E KK F 185 J - D 2**

- 1 Pump size (Suction×Discharge)  
50 : 65A×50A  
65 : 80A×65A
- 2 Impeller size  
150 - 210 (mm)
- 3 Impeller range  
2
- 4 Wet-end main material  
E : CFRETFE
- 5 Material of Bearing / Spindle  
CF : High density carbon /  
High purity alumina ceramic  
KK : SiC/SiC
- 6 Type of motor  
F : Flange motor
- 7 Motor output  
055 : 5.5kW  
075 : 7.5kW  
110 : 11kW  
150 : 15kW  
185 : 18.5kW  
220 : 22kW  
300 : 30kW
- 8 Standard for pipe connection and motor  
J : JIS flange +JIS motor  
I : ISO flange +IEC motor  
A : ANSI flange +JIS motor
- 9 Special version
 

Mark	Drain	Base	Special version
A	Without drain	With base	Standard
S			Special
D			Standard
X	With drain		Special
B	Without drain	Without base	Standard
Y			Special
E			Standard
Z	With drain		Special
- 10 Motor pole  
2 : 2 pole    4 : 4 pole

# Specifications

2 pole motor type

Model	Pump size Suction×Discharge	50Hz			60Hz			Motor kW					
		Impeller size	Capacity L/min	Head m	Impeller size	Capacity L/min	Head m						
MDM50-2 (Impeller range 2)	65A×50A	210	417	62.0	210	500	88.5	5.5, 7.5, 11, 15, 18.5, 22, 30					
		205		58.0	205		83.5						
		200		51.0	200		74.0						
		190		48.0	190		68.5						
		180		42.0	180		61.0						
		170		36.5	170		53.0						
		160		32.0	160		45.5						
		150		27.0	150		39.5						
		MDM65-2 (Impeller range 2)		80A×65A	210		833		63.5	210	1000	90.5	5.5, 7.5, 11, 15, 18.5, 22, 30
					205				58.5	205		84.0	
200	51.0		200		72.5								
190	48.0		190		69.5								
180	42.0		180		60.5								
170	36.0		170		51.0								
160	30.5		160		44.0								
150	26.0		150		37.5								

4 pole motor

Model	Pump size Suction×Discharge	50Hz			60Hz			Motor kW
		Impeller size	Capacity L/min	Head m	Impeller size	Capacity L/min	Head m	
MDM50-2 (Impeller range 2)	65A×50A	210	208	15.5	210	250	22.0	5.5, 7.5, 11, 15
MDM65-2 (Impeller range 2)	80A×65A	210	417	16.0	210	500	23.0	5.5, 7.5, 11, 15

# Dimensions in mm

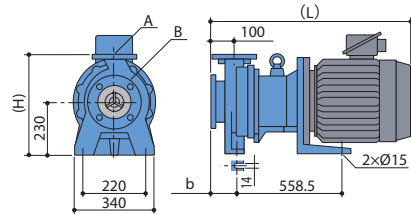
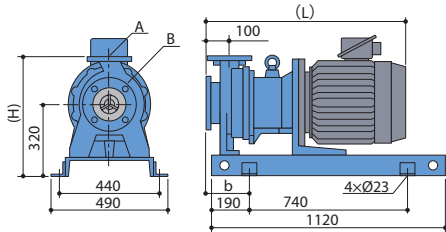

With base type

Model	Motor kW	(H)	(L)	b	A	B	Mass kg
MDM50-2	5.5	500	770	227.5	50A	65A	230
	7.5						235
	11						255
	15						265
	18.5						280
	22						380
MDM65-2	30	520	881	230	65A	80A	420
	5.5						230
	7.5						235
	11						255
	15						270
	18.5						285
	22		937				385
	30						425

Without base type

Model	Motor kW	(H)	(L)	b	A	B	Mass kg
MDM50-2	5.5	410	770	110.5	50A	65A	170
	7.5						175
	11						195
	15						210
	18.5						220
	22						320
MDM65-2	30	430	881	113	65A	80A	360
	5.5						170
	7.5						175
	11						200
	15						210
	18.5						235
	22		937				325
	30						365

**IWAKI CO., LTD.** 6-6 Kanda-Sudacho 2-chome Chiyoda-ku Tokyo 101-8558 Japan TEL : (81)3 3254 2935 FAX : 3 3252 8892 IWAKI has global net work. Please find your distributor location at [www.iwakupumps.jp](http://www.iwakupumps.jp)

European office : IWAKI Europe GmbH  
 Germany : IWAKI Europe GmbH  
 Holland : IWAKI Europe GmbH (Netherlands Branch)  
 Italy : IWAKI Europe GmbH (Italy Branch)  
 Spain : IWAKI Europe GmbH (Spain Branch)  
 Belgium : IWAKI Belgium N.V.  
 Denmark : IWAKI Nordic A/S  
 Finland : IWAKI Suomi Oy  
 France : IWAKI France S.A.  
 Norway : IWAKI Norge AS  
 Sweden : IWAKI Sverige AB

TEL: (49)2154 9254 0 FAX: 2154 9254 48  
 TEL: (49)2154 9254 50 FAX: 2154 9254 55  
 TEL: (31)74 2420011 FAX: (49)2154 925448  
 TEL: (39)0444 371115 FAX: 0444 335350  
 TEL: (34)93 37 70 198 FAX: 93 47 40 991  
 TEL: (32)13 67 02 00 FAX: 13 67 20 30  
 TEL: (45)48 24 2345  
 TEL: (358)9 2745810  
 TEL: (33)1 69 63 33 70 FAX: 1 64 49 92 73  
 TEL: (47)23 38 49 00  
 TEL: (46)8 511 72900

U.S.A. : IWAKI America Inc.  
 Argentina : IWAKI America Inc. (Argentina Branch)  
 Brasil : IWAKI Do Brasil Comercio De Bombas Hidraulicas Ltda.  
 Singapore : IWAKI Singapore Pte Ltd.  
 Indonesia : IWAKI Singapore (Indonesia Office)  
 Malaysia : IWAKI Sdn. Bhd.  
 Australia : IWAKI Pumps Australia Pty Ltd.  
 Hong Kong : IWAKI Pumps Co., Ltd.  
 China : GFTZ IWAKI Engineering & Trading Co., Ltd.  
 : IWAKI Pumps (Shanghai) Co., Ltd.  
 Korea : IWAKI Korea Co., Ltd.  
 Taiwan : IWAKI Pumps Taiwan Co., Ltd.  
 Thailand : IWAKI (Thailand) Co., Ltd.

TEL: (1)508 429 1440 FAX: 508 429 1386  
 TEL: (54)11 4745 4116  
 TEL: (55)19 3244 5900 FAX: 19 3244 5900  
 TEL: (65)6316 2028 FAX: 6316 3221  
 TEL: (62)21 6906606 FAX: 21 6906612  
 TEL: (60)3 7803 8807 FAX: 3 7803 4800  
 TEL: (61)2 9899 2411 FAX: 2 9899 2421  
 TEL: (852)2607 1168 FAX: 2607 1000  
 TEL: (86)20 84350603 FAX: 20 84359181  
 TEL: (86)21 6272 7502 FAX: 21 6272 6929  
 TEL: (82)2 2630 4800 FAX: 2 2630 4801  
 TEL: (886)2 8227 6900 FAX: 2 8227 6818  
 TEL: (66)2 322 2471 FAX: 2 322 2477

**Caution for safety use:** Before use of pump, read instruction manual carefully to use the product correctly. Actual pumps may differ from the photos. Specifications and dimensions are subject to change without prior notice. For further details please contact us.

**Legal attention related to export.** Our products and/or parts of products fall in the category of goods contained in control list of international regime for export control. Please be reminded that export license could be required when products are exported due to export control regulations of countries. The posting and copying from this catalogue without permission is not accepted firmly.